

Item	Description	HP Part No.	Qty.
1	Thermal Strap	19232- 00040	1
2	Insulation	19232- 40010	1
3*	TCD Assembly:		
	(new)	19232- 60670	1
	(rebuilt)	19232- 69510	1
4	Heater/Sensor Assy	05890- 61140	1
5	● Heater, 70 W	19231- 60620	1
6	● Contact	1251- 1679	2
7	● PRT Sensor	19231- 60660	1
8	● Contact	1251- 5963	2
9	● PRT Delta- T Sensor	19232- 60660	1
10	● Flexible Sleeving, (ordered by the inch)	0890- 0737	22
11	Screw, M4 x 8 mm long	0515- 0910	8
12	Switching (Solenoid) Valve Assy	19232- 60570	1
13	Fitting, Plastic	05890- 40050	1
14	TCD Mounting Bracket	19232- 00030	1
15	TCD Make- up Gas Adaptor (Refer to Figure 7 for additional adaptors)	19232- 80550	1
16	Ref. Gas 1/16- inch Tubing	19232- 80500	1

Figure 1. Thermal Conductivity Detector (TCD) (Sheet 1 of 2).

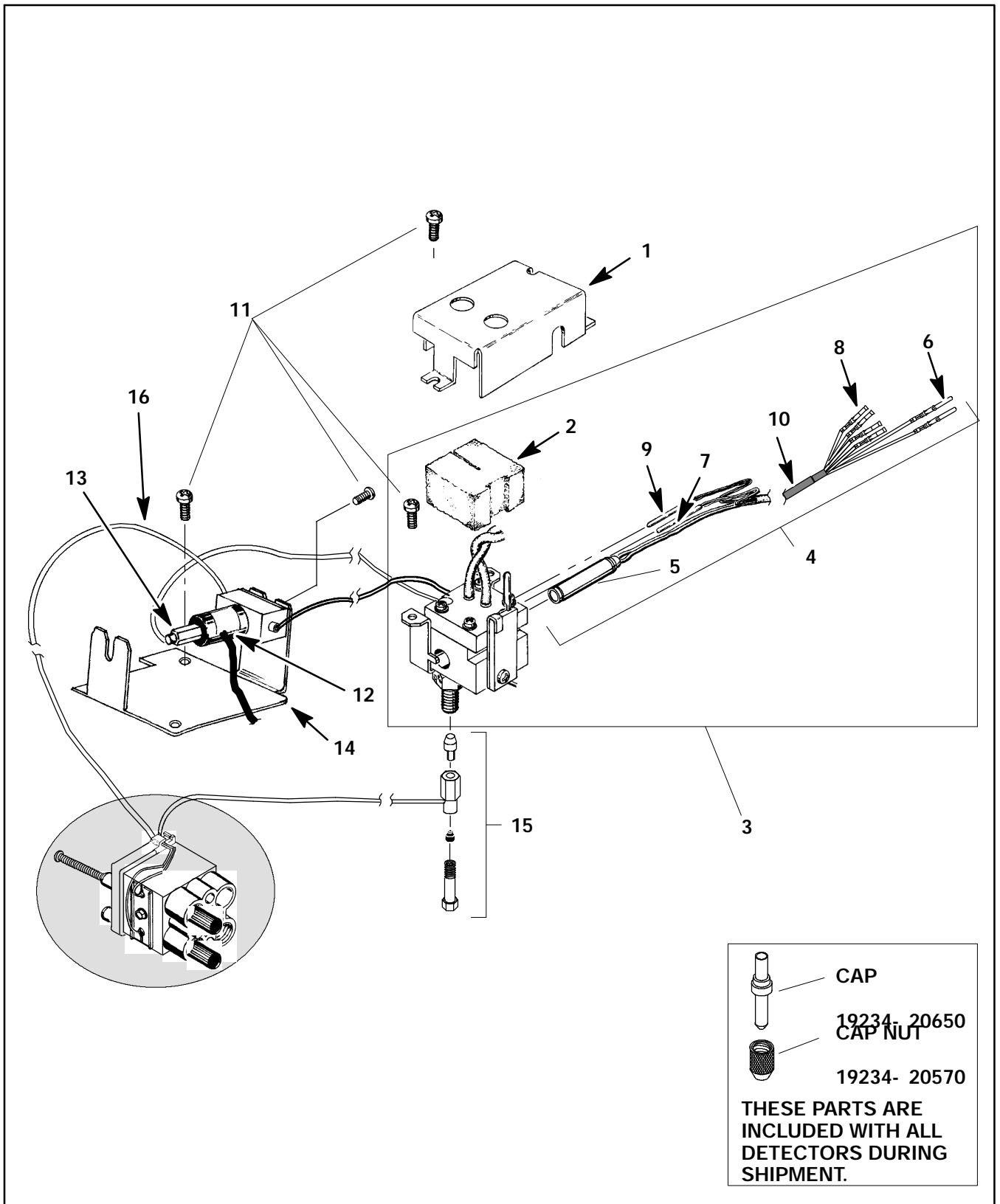

Figure 1. Thermal Conductivity Detector (TCD) (Sheet 2 of 2).